

a l b i o n performing a r t s c e n t e r



site plan



stage

the overall concept of the project is to take a typical performance hall distill it down to its most basic elements pull them apart, then modify the components and re-assemble them in a new and different way. the large linear lobby runs along the side of the theater and with its green wall system continues the tree massing along the street that is present along the east side of the site. the theater itself is all glass maintaining the open space feel between the green massing along the street and the solid mass of the school, this progresses into a outdoor courtyard space outside of the backstage area. a large concrete wall forms the frame of the stage and also ties all the elements of the theater together an connects them with the existing building. there is a basement under the stage and room additions for storage of equipment and chairs, which is accessible from an elevator in the stage. the curtain wall in the backstage area has large removable panels to allow for large set pieces to be brought in. the theater has the ability to seat 384 people in the permanent seating with the ability to double that with the use of flexible seating.

benton cooper

spring 2010

e: bc_cobra@hotmail.com

m: 402.366.0386



lobby



courtyard

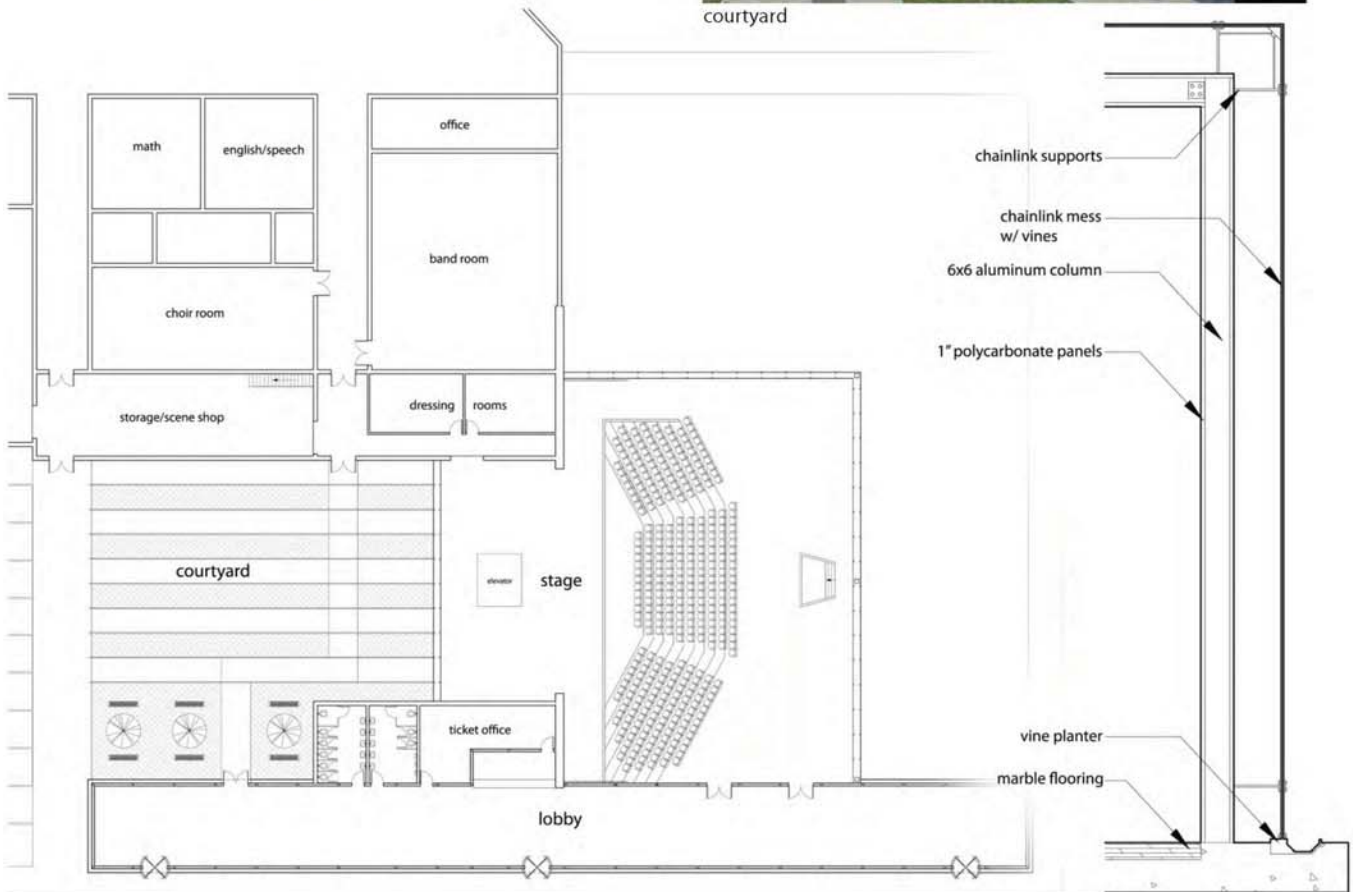

floor plan



greenwall detail