

REVITALIZING NEGATIVE SPACES

ALLEYS AND DEAD SPACES

Alley, city block between 3rd and 4th st. | Designer: Cinthia Barragan

The project intention was to give life to spaces like alleys and back of the buildings that people do not really think about as utilitarian. This art gallery-workshop-exhibition space, was designed on an alley taking advantage of the adjacent buildings walls and the great centric location of the site.



SHADING

SHADING THE EXTERIOR, INTERIOR AND SURROUNDING AREAS OF A STRUCTURE IS THE FIRST LINE OF ACTION TO REDUCE THE TEMPERATURE BUILD UP DUE SOLAR INCIDENCE. THE PLANTING OF TREES, BUSHES, OR VINES IN APPROPRIATE PLACES CAN HELP TO CUT SOLAR GAIN INTO A BUILDING YET ALLOWING COOLING BREEZES TO FLOW THROUGH.

A SPACE TO INTERACT, WORK AND EXHIBIT

REPIONEERING

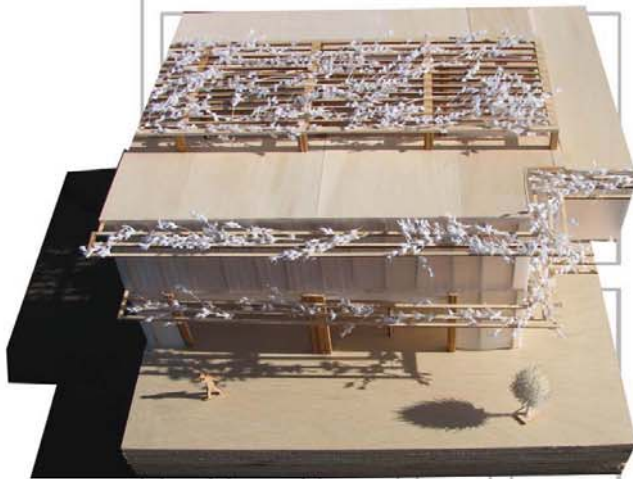

A FACILITY THAT GLOWS LIGHT

