

# Pin-wheel energy

Designed by: Dalal Al-Qattan

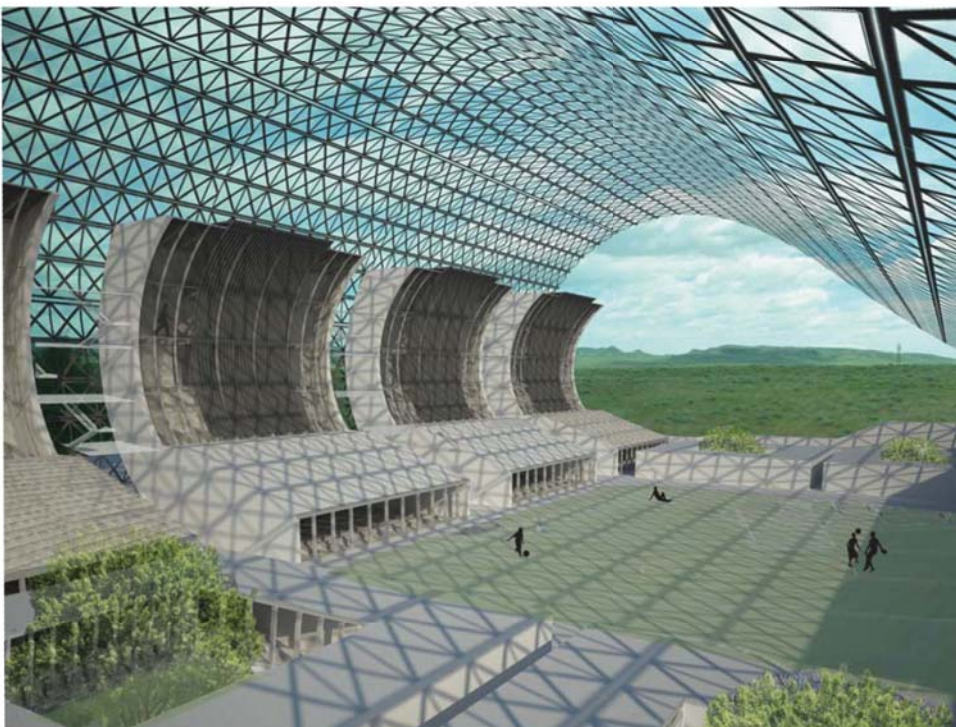

The form protects the school from the harsh winter winds, while harvesting wind energy via thousands of little wind turbines during the summer months when the shell is left open. Due to the vastness of scale, the energy can be tied back into the grid of albion and provide clean energy for the county. During the winter months when the shell is closed, the stationary turbines collect solar energy. With the shell structure made up of ETFE panels, students can enjoy the feel of the outside while

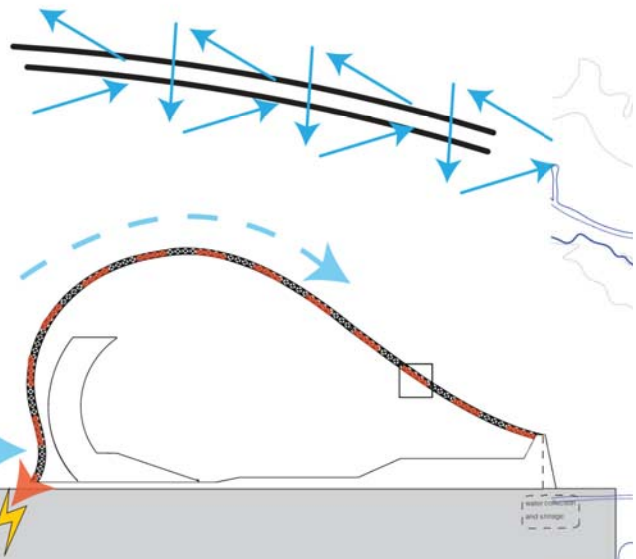
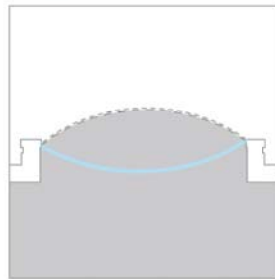
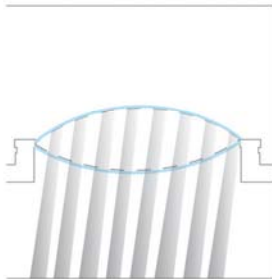
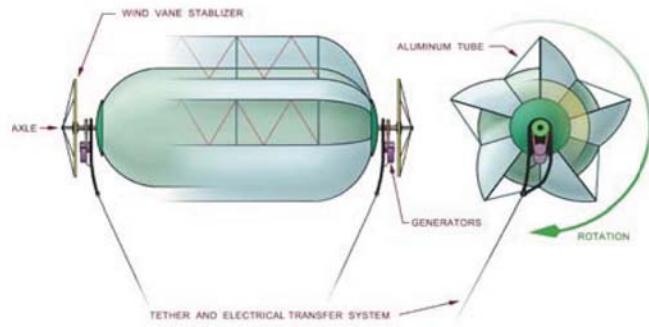
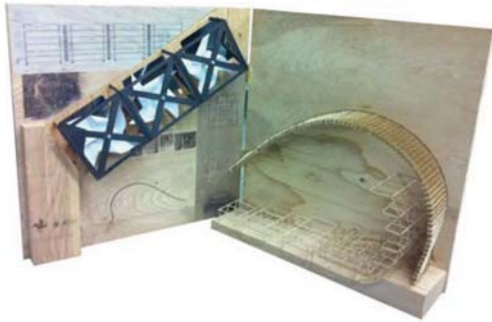